

- **Présentation**
- **Voorstelling**
- **Presentation**
- **Aufmachung**
- **Presentación**
- **Presentazione**
- **Apresentação**

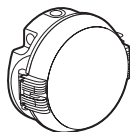

0 624 26



ERP : 850∞C



IP 54



EN60-598-1



0 624 26 : IK 08 (5 joules)



2G7 9W

- Non fournie
- Niet geleverd
- Not supplied
- Getrennt zu bestellen
- No suministrada
- Non fornita
- Não fornecido



- **Installation**
- **Instalación**
- **Installatie**
- **Installazione**
- **Installation**
- **Instalação**
- **Montage**

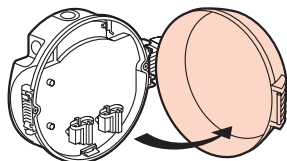
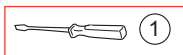

1

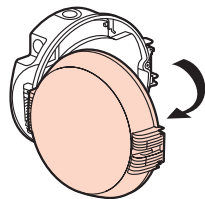
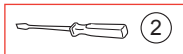
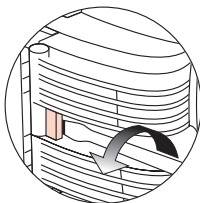

2

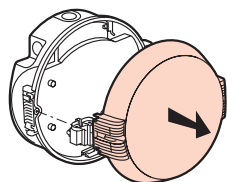
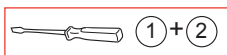
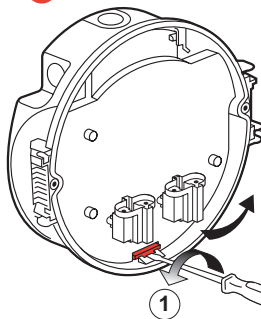

3

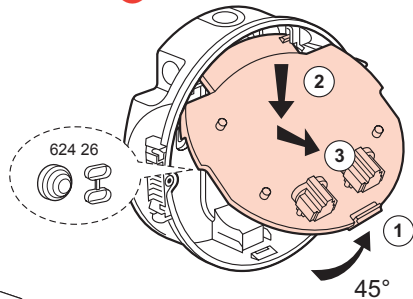

45°

624 26

- Arrivée des conducteurs
- Aankomst van de geleiders
- Incoming conductors
- Leitungseinführung
- Llegada de cables
- Entrada cavi
- Entrada de condutores

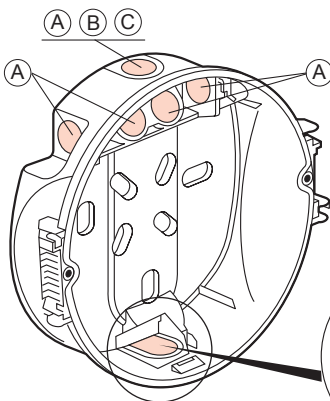
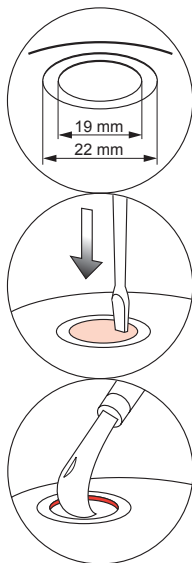

Ø 22	Ø 19	Ø 19
A	B	C
	ISO 20 + 0 980 86 + 0 980 22	PG 11 + 0 980 22
• ou • of • or • oder • o • o • ou • o • i		• ou • of • or • oder • o • o • ou • o • i

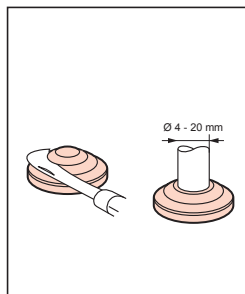

- Moulure type DLP
- Lijst type DLP
- DLP type moulding
- Leitungseinführung-Kabelkanal DLP
- Canal tipo DLP
- Minicanali tipo DLP
- Rodapé tipo DLP

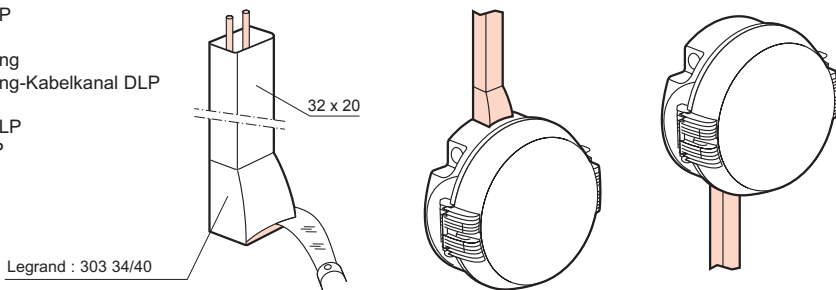

- Fixation
- Bevestiging
- Extension
- Befestigung
- Fijación
- Fissaggio
- Fixação

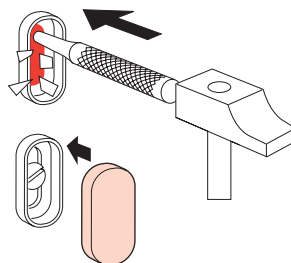
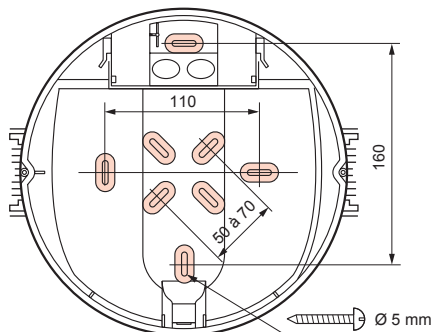

- Raccordement
- Aansluiting
- Connections
- Anschließen
- Conexión
- Collegamento
- Ligação

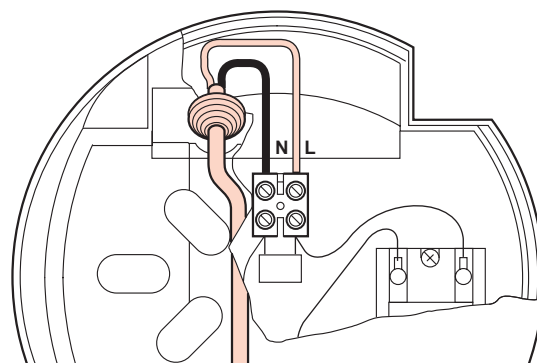
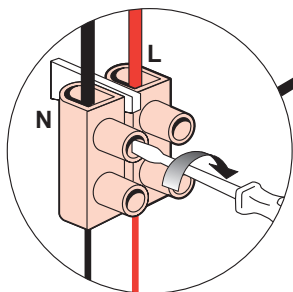
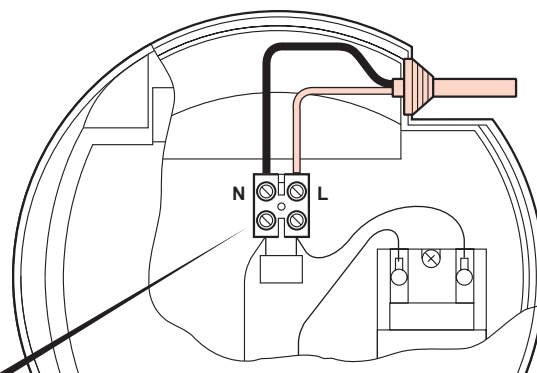
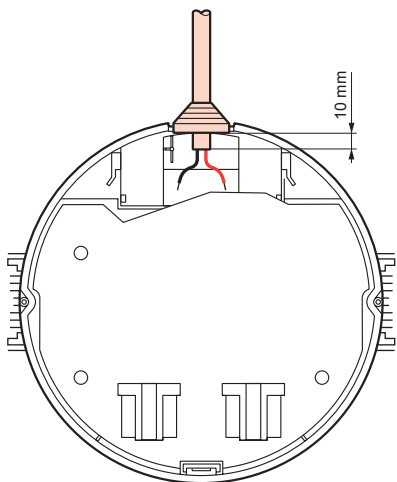
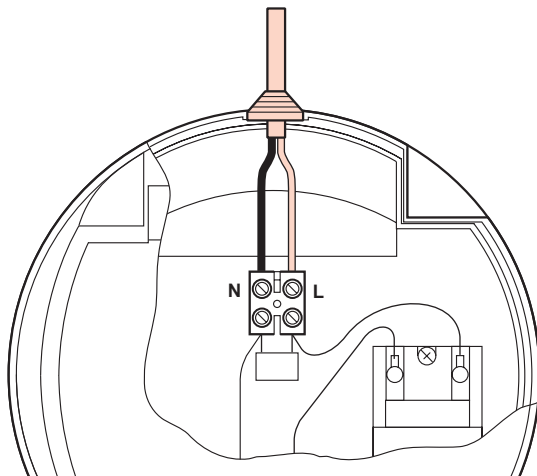

- Remontage
- Hermontage
- Reassembly
- Montage
- Montaje
- Montaggio
- Montagem
- Montage

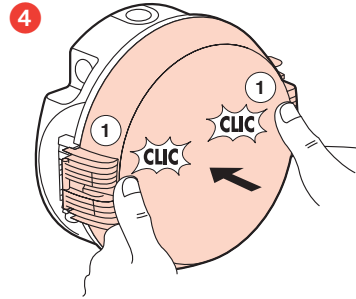
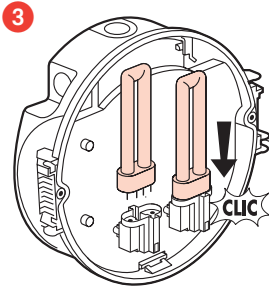
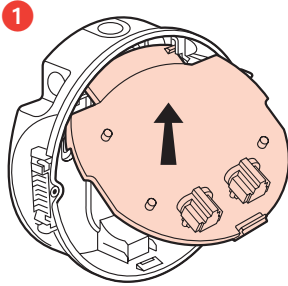

- Maintenance
- Onderhoud
- Maintenance
- Wartung
- Mantenimiento
- Manutenzione
- Manutenção

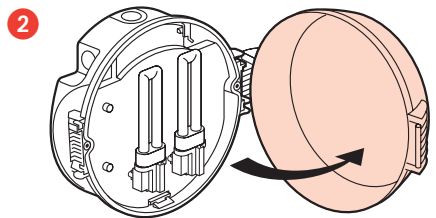
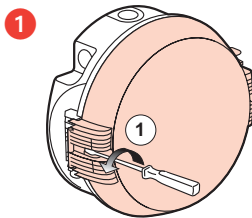

- Extension
- Uitbreiding
- Extension
- Anschließen weiterer leuchten
- Extensión
- Derivazione
- Extensão

